

## TABLE LAMP | YVES NICKEL

### LAMP BASE

Material: Metal  
Finish shown: Polished Nickel  
Code: TL-YVES-PLNL

### LAMPSHADE AS SHOWN

20" Oval Ivory Satin  
Shade code: SH-20-OVAL-YVE  
Shade lining: Gold PVC

### FLEX

1.5 metres of Black twisted flex.

### SWITCHING, PLUG & VOLTAGE

UL polarized Type A plug & inline on/off switch. 110-120V 50-60Hz.

### WEIGHT

5.9lbs approx

### LAMPING

2 x E26 Lampholder - 60W max. LED bulb recommended.

### WARRANTY

12 months

### FINISHING NOTE

All metalwork is handcrafted and may vary from piece to piece with slight variation in finish and detailing.

### CLEANING INSTRUCTIONS

The finishes on this luminaire only require regular cleaning with a soft dry duster. Abrasive or chemical cleaners may harm the finish and should not be used. Shade to be dusted with a clean dry cloth.

### OUR U.S. COLLECTION

This product is wired using UL listed components and is fully compliant with UL regulations.

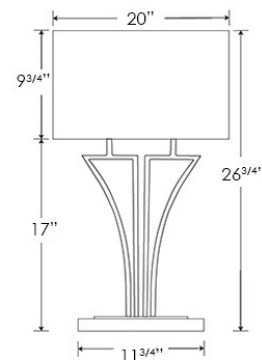

Dimensions in Inches and approximate

# H&CO

Decorative lighting  
for beautiful spaces

[www.heathfield.co.uk](http://www.heathfield.co.uk) | + 44 (0) 1732 350450 | [sales@heathfield.co.uk](mailto:sales@heathfield.co.uk)

Unit 1, Priory Road, Tonbridge, Kent, TN9 2AF, United Kingdom